

Specifically designed for indoor and outdoor promotions or high traffic areas of display. Blizzard's moulded base can be filled with either water or sand to provide stability in adverse weather conditions.



features & benefits

- Ideal for point of sale, retail display or exhibition environments
- Stylish design hollow plastic base for water or sand weighting agent
- Fully adjustable graphic height and width
- Graphic supported on simple eyelet system
- Weather resistant

800mm (max)
600mm (min)



2000mm (max)
1500mm (min)

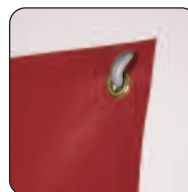

Position eyelet centres 30mm in from each graphic corner

Graphic dimensions and eyelet positioning



hardware specifications	graphic specifications	additional info
<p>Assembled Dimensions (mm): 2100 (h) x 800 (w) x 540 (d) approx (based upon 2000 x 800 graphic)</p> <p>Base footprint: 540 (w) x 455 (d) x 186 (h) approx</p> <p>Weight: 3.2kg approx when empty and 19.60kg approx when filled with water. (requires 21 litres approx)</p>	<p>Please refer to graphic template</p>	<p>Included in kit: Base, telescopic pole /support arms and bottom rail.</p> <p>Availability: Anodised silver/blue base</p> <p>Optional accessories: Carry bag AB140-C</p>

Assembly Instructions

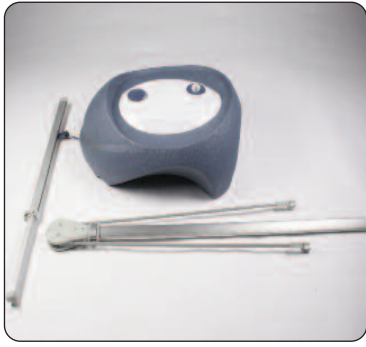

Kit includes: Base, telescopic pole /support arms and bottom rail.



1 Remove cap and fill the base with water or sand.

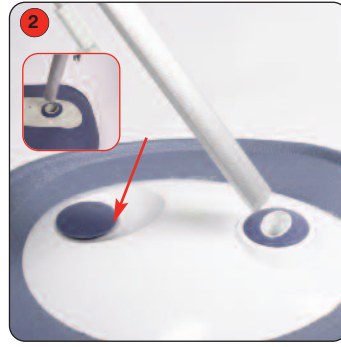

2 Insert the telescopic pole set into the base.

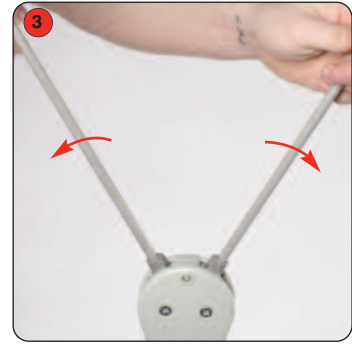

3 Open out the banner support arms.



4 Attach the top graphic eyelets to the support arm hooks.

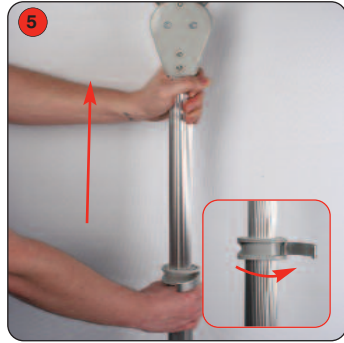

5 Release catch, then raise the pole to the desired height.



6 Snap the catch closed to lock pole in position

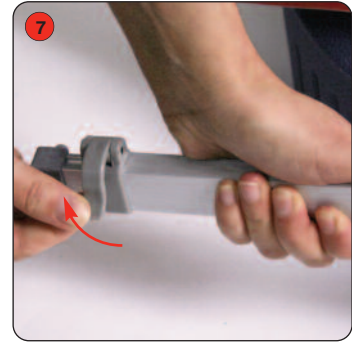

7 Unlock the telescopic bottom rail by lifting up the lever.

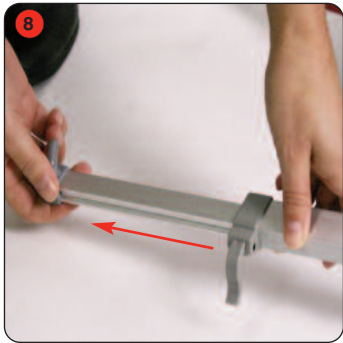

8 Extend the bottom rail to suit the graphic width.

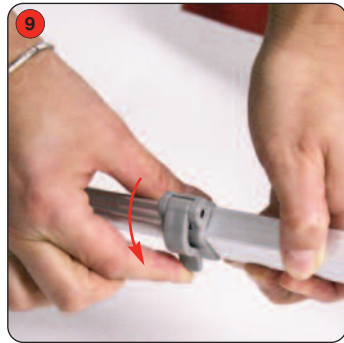

9 Push down on the lever to lock the rail into place

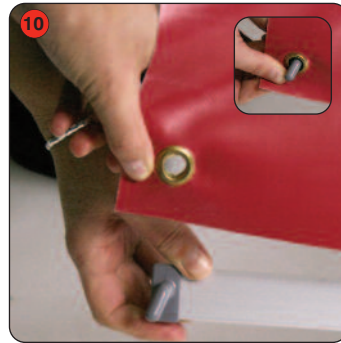

10 Attach the bottom graphic eyelets to the rail hooks.

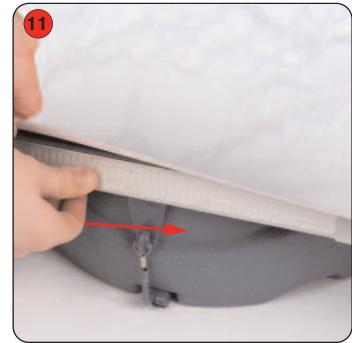

11 Slide the rail stay cord to the centre of the base.



12 If necessary adjust the telescopic pole to add tension to the graphic.

